

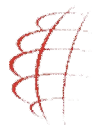

**Global Light Solutions**  
illuminazione a led

## Catalogo Flood light



**Global Elektro**  
division

# Fari Flood

**DRIVERLESS**



10-20W



30W



50W



100W



150W

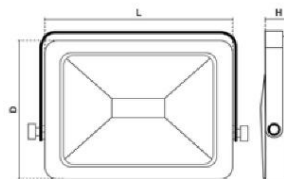

Codice	Potenza	Colore	Lumen	Angolo	CRI	Dimensioni DxLxh	Alimentazione
GL64-FL010-C30-FA0	10W	3000K	800	110°	≥70	12x10.6x4	220-240Vac
GL64-FL010-P40-FA0		4000K	850				
GL64-FL010-C65-FA0		6500K	850				
GL64-FL020-C30-FA0	20W	3000K	1600	110°	≥70	12x10.6x4	220-240Vac
GL64-FL020-P40-FA0		4000K	1700				
GL64-FL020-C65-FA0		6500K	1700				
GL64-FL030-C30-FA0	30W	3000K	2400	110°	≥70	18x17.5x4.5	220-240Vac
GL64-FL030-P40-FA0		4000K	2600				
GL64-FL030-C65-FA0		6500K	2600				
GL64-FL050-C30-FA0	50W	3000K	4000	110°	≥70	22.7x22x5.2	220-240Vac
GL64-FL050-P40-FA0		4000K	4300				
GL64-FL050-C65-FA0		6500K	4300				
GL64-FL100-C30-FA0	100W	3000K	8000	110°	≥70	28.7x27x6.1	220-240Vac
GL64-FL100-P40-FA0		4000K	8500				
GL64-FL100-C65-FA0		6500K	8500				
GL64-FL150-C30-FA0	150W	3000K	12000	110°	≥70	34x30x7	220-240Vac
GL64-FL150-P40-FA0		4000K	12750				
GL64-FL150-C65-FA0		6500K	12750				

## Fari Flood



10W



20W



30W



50W



100W

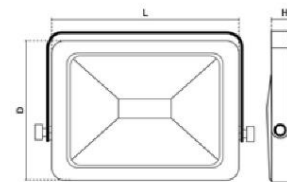

Codice	Potenza	Colore	Lumen	Angolo	CRI	Dimensioni DxLxh	Alimentazione
GL64-FL010-C30-SL3	10W	3000K	900	110°	≥70	13.4x12.5x2.6	220-240Vac
GL64-FL010-P40-SL3		4000K	970				
GL64-FL010-C65-SL3		6500K	1000				
GL64-FL020-C30-SL3	20W	3000K	1800	110°	≥70	19x18.9x3.6	220-240Vac
GL64-FL020-P40-SL3		4000K	1940				
GL64-FL020-C65-SL3		6500K	2000				
GL64-FL030-C30-SL3	30W	3000K	2700	110°	≥70	23.8x23.3x4	220-240Vac
GL64-FL030-P40-SL3		4000K	2900				
GL64-FL030-C65-SL3		6500K	3000				
GL64-FL050-C30-SL3	50W	3000K	4500	110°	≥70	29.8x28.8x4.4	220-240Vac
GL64-FL050-P40-SL3		4000K	4850				
GL64-FL050-C65-SL3		6500K	5000				
GL64-FL100-C30-SL3	100W	3000K	9000	110°	≥70	35.4x34.8x4.8	220-240Vac
GL64-FL100-P40-SL3		4000K	9700				
GL64-FL100-C65-SL3		6500K	10000				

## Fari Flood

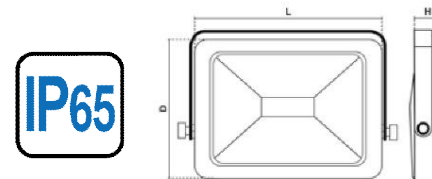

Codice	Potenza	Colore	Lumen	Angolo	CRI	Dimensioni DxLxh	Alimentazione
GL64-FL010-C30-SL1	10W	3000K	850	100°	≥80	15x10.2x3.1	220-240Vac
GL64-FL010-P40-SL1		4000K	950				
GL64-FL010-C65-SL1		6500K	900				
GL64-FL020-C30-SL1	20W	3000K	1650	100°	≥80	19.3x12.6x3.3	220-240Vac
GL64-FL020-P40-SL1		4000K	1700				
GL64-FL020-C65-SL1		6500K	1750				
GL64-FL030-C30-SL1	30W	3000K	2400	100°	≥80	22.1x14.4x4.1	220-240Vac
GL64-FL030-P40-SL1		4000K	2500				
GL64-FL030-C65-SL1		6500K	2550				
GL64-FL050-C30-SL1	50W	3000K	3900	100°	≥80	22.8x16x4.3	220-240Vac
GL64-FL050-P40-SL1		4000K	4000				
GL64-FL050-C65-SL1		6500K	4000				

## Fari Flood ECOline



10W



20W



30W



50W



100W

IP65

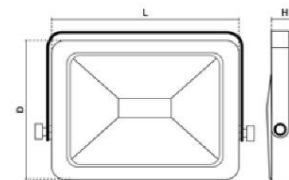

Codice	Potenza	Colore	Lumen	Angolo	CRI	Dimensioni DxLxh	Alimentazione
GL64-FL010-C30-FA2	10W	3000K	800	110°	≥70	12x10.6x3.5	220-240Vac
GL64-FL010-P40-FA2		4000K	850				
GL64-FL010-C65-FA2		6500K	850				
GL64-FL020-C30-FA2	20W	3000K	1600	110°	≥70	17x14.7x3.5	220-240Vac
GL64-FL020-P40-FA2		4000K	1700				
GL64-FL020-C65-FA2		6500K	1700				
GL64-FL030-C30-FA2	30W	3000K	2400	110°	≥70	20.5x17.5x3.7	220-240Vac
GL64-FL030-P40-FA2		4000K	2600				
GL64-FL030-C65-FA2		6500K	2600				
GL64-FL050-C30-FA2	50W	3000K	4000	110°	≥70	20.7x25x3.7	220-240Vac
GL64-FL050-P40-FA2		4000K	4300				
GL64-FL050-C65-FA2		6500K	4300				
GL64-FL100-C30-FA2	100W	3000K	8000	110°	≥70	24.9x31x4	220-240Vac
GL64-FL100-P40-FA2		4000K	8500				
GL64-FL100-C65-FA2		6500K	8500				

## Fari Flood 12-24 Vdc



IP65

Codice	Potenza	Colore	Lumen	Angolo	CRI	Dimensioni DxLxh	Alimentazione
GL64-FL010-C65-12/24	10W	6500K	900	100°	≥70	16x10.8x5	12-24Vdc
GL64-FL020-C65-12/24	20W	6500K	1800	100°	≥70	20x14x60	12-24Vdc
GL64-FL030-C65-12/24	30W	6500K	2700	100°	≥70	20x14x62	12-24Vdc
GL64-FL050-C65-12/24	50W	6500K	4500	100°	≥70	25x18.7x6.3	12-24Vdc

## Fari Flood speciali

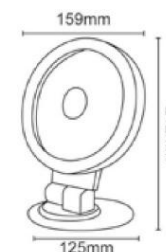

IP65

Codice	Potenza	Colore	Lumen	Angolo	CRI	Dimensioni DxLxh	Alimentazione
GL64-FL020-W30-F70	20W	3000K	1350	120°	≥80	Ø15.9x12.5x21.2	220-240Vac
GL64-FL020-P40-F70	20W	4000K	1400	120°	≥80	Ø15.9x12.5x21.2	220-240Vac
GL64-FL020-C65-F70	20W	6500K	1500	120°	≥80	Ø15.9x12.5x21.2	220-240Vac
GL64-FL020-RGB-F70	20W	RGB	4500	120°	≥80	Ø15.9x12.5x21.2	220-240Vac

## Fari Flood alta potenza



160W



240W



240W

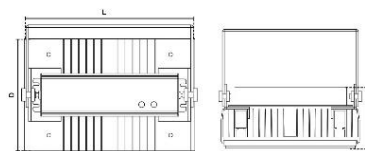

Codice	Potenza	Colore	Lumen	Angolo	CRI	Dimensioni DxLxh	Alimentazione
GL64-FL160-P40	160W	4000K	20000	45°	≥70	28.9x17.8x17.5	220-240Vac
GL64-FL240-P40	240W	4000K	30000	45°	≥70	28.9x27.2x17.5	220-240Vac
GL64-FL240-P40-FD1	240W	4000K	21600	60°	≥70	34.1x42.5x6.8	220-240Vac



60W



120W



180W



240W



300W



Codice	Potenza	Colore	Lumen	Angolo	CRI	Dimensioni DxLxh	Alimentazione
GL45-FL060-P40-EVO	60W	4000K	6000	90°	≥75	32.5x9x9	200-240Vac
GL45-FL120-P40-EVO	120W	4000K	14155	90°	≥75	32.5x9x17	200-240Vac
GL45-FL180-P40-EVO	180W	4000K	18360	90°	≥75	32.5x9x25	200-240Vac
GL45-FL240-P40-EVO	240W	4000K	28783	90°	≥75	32.5x9x33	200-240Vac
GL45-FL300-P40-EVO	300W	4000K	36053	90°	≥75	32.5x9x41	200-240Vac

## Accessori



Staffa per fissaggio a parete faro Flood da10 a 50W

Dimensioni : 554x150x82

GLM64-63A01



Staffa per fissaggio a parete faro Flood da10 a 50W

Dimensioni : 85x150x82

GLM08-794-3623



Staffa per fissaggio a parete faro Flood da70 a 200W

Dimensioni : 87x150x82

GLM08-793-3622



Connettore di giunzione IP68 3 poli 17A

GLM64-6800202



Pres a volante IP68 3 poli 17A

GLM64-6802002



Spina volante IP68 3 poli 17A

GLM64-6801602



## Dove siamo



### Global Elektro di Ritella Francesco

C.so Europa,601  
10088 Volpiano (TO)  
Italy

Web : [www.globallight.it](http://www.globallight.it)

Email : [info@globallight.it](mailto:info@globallight.it)

Tel.: +39 392 9208894 - Francesco  
+39 328 9787001 - Luca